



Toll Free (800) 242-8511
Madison Area (608) 229-1181
Hearing Impaired: TDD (800) 542-2289
www.diggershotline.com

LEGEND

	PROPERTY LINE
	LIMIT OF WORK
	SILT FENCE OR SEDIMENT SOCK
	FENCE
	STORM SEWER
	EXISTING SANITARY SEWER
	EXISTING WATER MAIN
	EXISTING STORM SEWER
	EXISTING BURIED ELECTRIC LINES
	EXISTING OVERHEAD ELECTRIC LINES
	EXISTING BURIED FIBER OPTIC
	EXISTING 5-FT INDEX CONTOUR
	EXISTING 1-FT INTERMEDIATE CONTOUR
	EXISTING WATERLINE
	BOULDER WALL
	5-FT INDEX CONTOUR
	1-FT INTERMEDIATE CONTOUR
	CONTROL POINT/BENCHMARK
	GUTTER DOWNSPOUT
	EXISTING RIPRAP
	CONCRETE PAVEMENT
	ASPHALT PAVEMENT - LIGHT DUTY
	ASPHALT PAVEMENT - HEAVY DUTY
	COMPACTED AGGREGATE BASE COURSE
	INLET PROTECTION (TYP)
	STONE TRACKING PAD
	SEDIMENT SOCK OR SILT FENCE



901 DENNING WAY, SUITE 102 | MADISON, WI 53717
Ph: 608.664.3500 | Fx: 608.664.3535
iconicaplanning.com

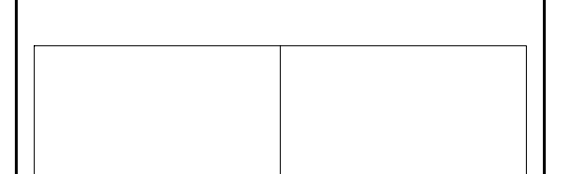

901 DENNING WAY, SUITE 102
MADISON, WI 53717
608.858.8588

ATLANTISVALLEY FOODS
303 COMMERCE PARKWAY
COTTAGE GROVE, WI 53527

ATLANTISVALLEY FOODS
300 COMMERCE PARKWAY
COTTAGE GROVE, WI 53527

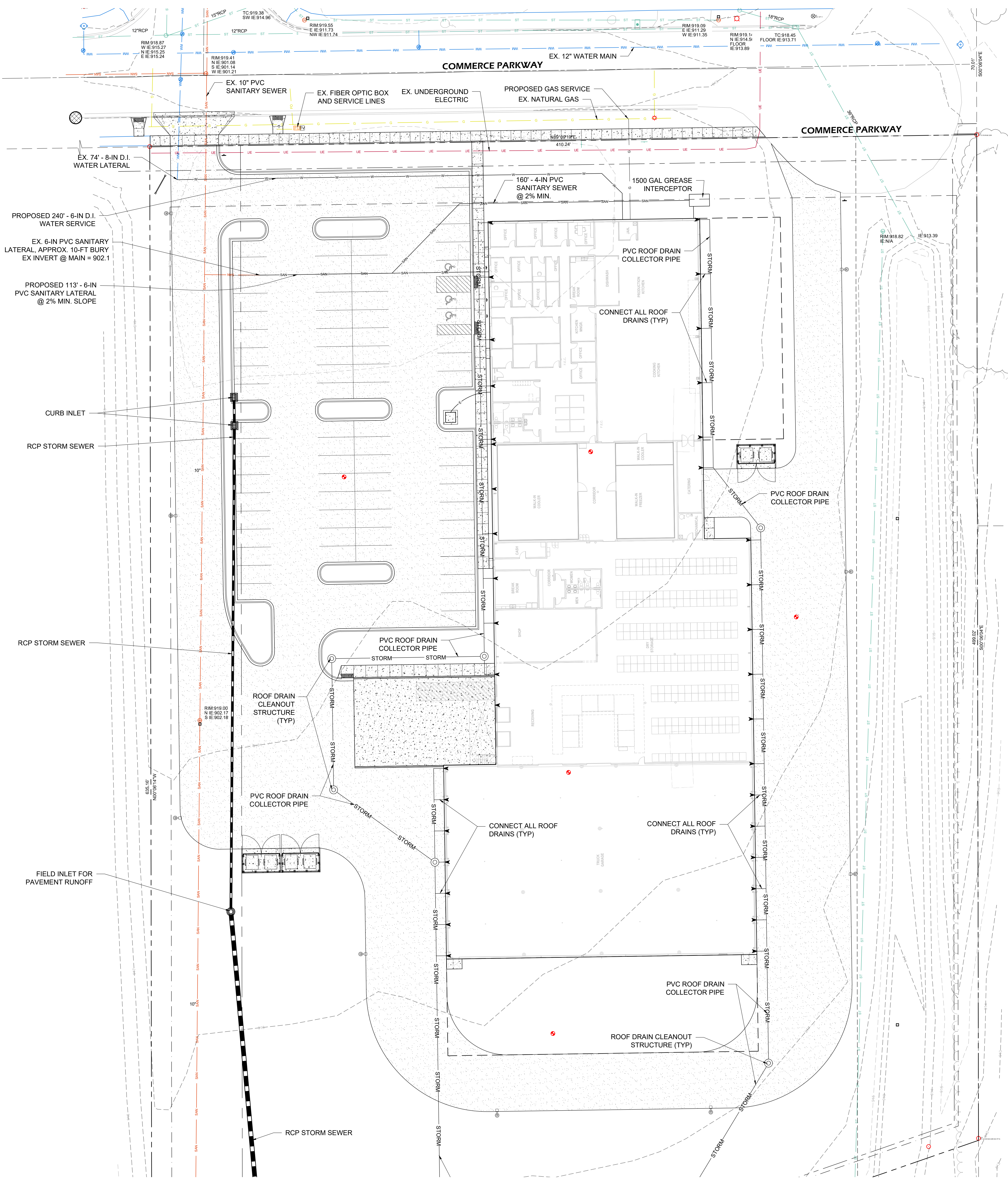

UTILITY NOTES:

- THE CONTRACTOR SHALL CONTACT DIGGERS HOTLINE A MINIMUM OF 3 WORKING DAYS PRIOR TO THE START OF CONSTRUCTION.
- STANDARD SPECIFICATIONS: PERFORM ALL WORK IN ACCORDANCE WITH THE PROVISIONS OF:
 - "STANDARD SPECIFICATIONS FOR SEWER AND WATER CONSTRUCTION IN WISCONSIN" (WWS) LATEST EDITION
 - STATE OF WISCONSIN DEPARTMENT OF TRANSPORTATION, DIVISION OF HIGHWAYS STANDARD SPECIFICATIONS FOR ROAD AND BRIDGE CONSTRUCTION" (WISDOT) LATEST EDITION
- CONTRACTOR SHALL OBTAIN A CURRENT COPY OF THE VILLAGE OF COTTAGE GROVE STANDARD SPECIFICATIONS INCLUDING ALL SUPPLEMENTAL SPECIFICATIONS AND OTHER REVISIONS TO DATE, UNLESS OTHERWISE SPECIFIED IN THE SPECIFICATIONS, PRIOR TO THE START OF CONSTRUCTION.

STORM SEWER:

- STORM SEWER OR CULVERTS WITHOUT DESIGNATED PIPE TYPES MAY BE SELECTED FROM THE MATERIALS LISTED IN THE SPECIFICATIONS.
- STORM SEWER SPECIFIED AS RCP SHALL BE REINFORCED CONCRETE PIPE CONFORMING TO THE FOLLOWING SPECIFICATIONS:
 - 12" DIA - CLASS V RCP
 - 15" DIA - CLASS IV RCP
 - 18" DIA - CLASS III RCP
- STORM SEWER SPECIFIED AS HDPE SHALL BE CORRUGATED HDPE, SMOOTH INTERIOR.
- STORM SEWER SPECIFIED AS PVC SHALL BE SDR 26 PVC.
- POLYETHYLENE MATERIAL SHALL CONFORM TO ASTM D3350. AN APPROVED RUBBER GASKET JOINT SHALL BE USED FOR EITHER OPTION. JOINTS FOR RCP SHALL CONFORM TO ASTM D-471. JOINTS FOR HDPE SHALL CONFORM TO ASTM F-477.
- ALL PERFORATED UNDERDRAIN SHALL BE PERFORATED SDR26 PVC WITHOUT A FILTER SOCK.
- ALL APRON ENDWALLS SHALL BE PROVIDED WITH PIPE GRATES (TRASH GUARDS).

PLAN NORTH
UTILITY PLAN
1" = 20'-0"



ISSUE DATES:

Issue	Description	Date
CS1	CITY SUBMITTAL #1	04-28-21

PRELIMINARY NOT FOR CONSTRUCTION

This document contains confidential or proprietary information of Iconica. Neither the document nor the information herein is to be reproduced, distributed, used or disclosed, either in whole or in part, except as specifically authorized by Iconica.

Sheet Title
UTILITY PLAN

Project Number: 20210130
Sheet Number

C400

Copyright © 2018 by Iconica, All Rights Reserved
4/20/2021 9:08:30 AM